











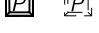
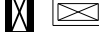



PAY ITEM NOTES:

1. 630-2-12: PAY ITEM SHALL INCLUDE VERIFYING VERTICALLY AND HORIZONTALLY (VVH) EXISTING UTILITIES PRIOR TO ANY DIRECTIONAL BORES.
2. 633-3-16: PAY ITEM SHALL INCLUDE PATCH PANELS THAT HAVE THE ABILITY TO STORE SPLICE TRAYS AS PART OF THE PATCH PANEL. FACTORY TERMINATED SINGLE MODE PATCH CORDS SHALL BE INCIDENTAL TO THIS ITEM. CONNECTORS SHALL BE AS REQUIRED BY THE EQUIPMENT AND PATCH PANELS INSTALLED. THE CABINET SHALL BE SIZED TO LENGTH (3' MINIMUM).
3. 633-8-1: PAY ITEM SHALL INCLUDE CABLE COMPRISED OF TWO (2) NO. 18 AWG GAUGE CONDUCTORS WITH INSULATED JACKET APPROVED FOR CONDUIT INSTALLATION.
4. 635-2-11, 635-2-12: PAY ITEM SHALL INCLUDE ALL MATERIALS AND WORK RELATED TO THE INSTALLATION OF A CONCRETE APRON.
5. 660-7-11, 660-7-12: PAY ITEM SHALL INCLUDE THE FURNISHING AND INSTALLATION OF A COMPLETE WRONG WAY DRIVING SYSTEM COMPATIBLE WITH THE EXISTING FDOT SYSTEM SOFTWARE. THE ASSEMBLY SHALL INCLUDE THERMAL IMAGING SENSORS, IN ACCORDANCE WITH FDOT STANDARD SPECIFICATIONS, SECTION 660.
6. 670-5-400: PAY ITEM SHALL INCLUDE UPDATING SIGNAL TIMING AS SHOWN IN THE PLANS.
7. 676-2-122: PAY ITEM SHALL INCLUDE ALL MATERIALS AND WORK RELATED TO THE INSTALLATION OF A CONCRETE TECHNICIAN PAD.  
  
THIS PAY ITEM SHALL ALSO INCLUDE ALL MATERIALS AND WORK NECESSARY TO REMOVE THE EXISTING TYPE TWO (2) CORBIN KEY LOCK SYSTEM AND INSTALL A NEW CYBERLOCK ELECTRONIC SYSTEM ON ALL CABINET DOORS. THE DEPARTMENT SHALL FURNISH ALL COMPONENTS FOR THE CYBERLOCK SYSTEM. CONTRACTOR SHALL COORDINATE EQUIPMENT PICK-UP WITH THE DEPARTMENT.  
  
THIS PAY ITEM SHALL ALSO INCLUDE THE INSTALLATION OF A REMOTE POWER MANAGER (RPM), AS NOTED ON THE PLANS. EACH RPM UNIT SHALL BE UL LISTED, INCLUDE A MINIMUM OF EIGHT (8) POWER OUTLETS, PROVIDE ETHERNET NETWORK CONNECTION, PROVIDE A MAXIMUM INPUT CURRENT OF 15 AMPS, AND PROVIDE 120 VOLTS OUTPUT TO DEVICES.
8. 676-2-500: PAY ITEM SHALL INCLUDE ALL WORK RELATED TO THE CABLING AND WIRING CONNECTIONS FOR THE INSTALLATION OF INDUCTIVE LOOP AND AXLE SENSORS WITHIN THE EXISTING TYPE 334 CABINET.  
  
THIS PAY ITEM SHALL ALSO INCLUDE THE INSTALLATION OF A REMOTE POWER MANAGER UNIT (RPMU), AS NOTED ON THE PLANS. EACH RPM UNIT SHALL BE UL LISTED, INCLUDE A MINIMUM OF EIGHT (8) POWER OUTLETS, PROVIDE ETHERNET NETWORK CONNECTION, PROVIDE A MAXIMUM INPUT CURRENT OF 15 AMPS, AND PROVIDE 120 VOLTS OUTPUT TO DEVICES.
9. 684-2-1: PAY ITEM SHALL INCLUDE DEVICE SERVER WITH A MINIMUM OF ONE (1) TCP/IP NETWORK INTERFACES VIA RJ-45 PORTS AND TWO (2) EIA-232/422/485 STANDARD CONNECTIONS FOR FIELD DEVICES.
10. 685-1-12: PAY ITEM SHALL INCLUDE THE FURNISH AND INSTALLATION OF AN ALPHA TECHNOLOGIES FXM 650 UPS WITH MICRO COMMUNICATION MODULE.  
  
ADDITIONALLY, PAY ITEM SHALL INCLUDE ONLY THE WORK NECESSARY TO FURNISH AND INSTALL REPLACEMENT BATTERIES FOR THE EXISTING UPS SYSTEM, AS WELL AS THE REMOVAL AND PROPER DISPOSAL OF EXISTING BATTERIES PER FLORIDA STATUTES AND EPA GUIDELINES, AS NOTED IN THE PLANS.
11. 695-3-11: PAY ITEM SHALL INCLUDE THE FURNISH AND INSTALLATION OF A RACK-MOUNTED PEEK ADR-3000 PLUS TRAFFIC COUNTER/CLASSIFIER UNIT WITH INDIVIDUAL PLUG-IN MODULES FOR INDUCTIVE LOOP AND PIEZO SENSORS, AS WELL AS A 115 VAC POWER SUPPLY, AND RS-232 COMMUNICATION INTERFACE.

PLAN LEGEND:

-  PULL BOX (13" X 24") (PROPOSED / EXISTING)
-  FIBER PULL BOX (24" X 36") (PROPOSED / EXISTING)
-  FIBER SPLICE VAULT (36" X 60" OR 30") (PROPOSED / EXISTING)
-  ELECTRICAL SERVICE DISCONNECT (PROPOSED / EXISTING)
-  CABINET - GROUND MOUNTED (PROPOSED / EXISTING)
-  CABINET - POLE MOUNTED (PROPOSED / EXISTING)
-  SINGLE DOOR NEMA 3R ENCLOSURE (PROPOSED / EXISTING)
-  SINGLE POST HIGHLIGHTED LED SIGN (PROPOSED / EXISTING)
-  MICROWAVE VEHICLE DETECTION RADAR (PROPOSED / EXISTING)
-  CCTV CAMERA (PROPOSED / EXISTING)
-  VIDEO VEHICLE DETECTION (PROPOSED / EXISTING)
-  TYPE "B" INDUCTIVE LOOP (PROPOSED / EXISTING)
-  PIEZOMETER AXLE SENSOR (EXISTING / PROPOSED)
-  UNDERGROUND CONDUIT (EXISTING)
-  CONDUIT - OPEN TRENCH (PROPOSED)
-  CONDUIT - DIRECTIONAL BORE (PROPOSED)

ACRONYMS:

- ATMS ADVANCED TRAFFIC MANAGEMENT SYSTEM
- AWG AMERICAN WIRE GAUGE
- CCTV CLOSED-CIRCUIT TELEVISION
- CKT CIRCUIT (ELECTRICAL)
- DMS DYNAMIC MESSAGE SIGN
- FDOT FLORIDA DEPARTMENT OF TRANSPORTATION
- FOC FIBER OPTIC CABLE
- FOSV FIBER OPTIC SPLICE VAULT
- GFCI GROUND-FAULT CIRCUIT INTERRUPTER
- GND GROUND (ELECTRICAL)
- GUI GRAPHICAL USER INTERFACE
- HDPE HIGH-DENSITY POLYETHYLENE
- HTTPS HYPERTEXT TRANSFER PROTOCOL SECURE
- IP INTERNET PROTOCOL
- ITS INTELLIGENT TRANSPORTATION SYSTEMS
- LED LIGHT-EMITTING DIODE
- LHUB LOCAL HUB
- MFES MANAGED FIELD ETHERNET SWITCH
- MM MULTI-MODE
- MVDS MICROWAVE VEHICLE DETECTION SYSTEM
- NEMA NATIONAL ELECTRICAL MANUFACTURERS ASSOCIATION
- PVC POLYVINYL CHLORIDE
- PWR POWER (ELECTRICAL)
- RGS RIGID GALVANIZED STEEL
- RPM REMOTE POWER MANAGER
- RU RACK UNIT
- SFP SMALL FORM-FACTOR PLUGGABLE
- SM SINGLE-MODE
- SPD SURGE PROTECTION DEVICE
- TMS TRAFFIC MONITORING SITE
- UPS UNINTERRUPTIBLE POWER SUPPLY
- VAC VOLTAGE ALTERNATING CURRENT
- VDC VOLTAGE DIRECT CURRENT
- VPN VIRTUAL PRIVATE NETWORK
- VVH VERIFICATION OF VERTICAL AND HORIZONTAL
- WAN WIDE AREA NETWORK
- WWD WRONG WAY DRIVING
- #/C NUMBER OF CONDUCTORS (ELECTRICAL)

REVISIONS				FLORIDA DEPARTMENT OF TRANSPORTATION 719 SOUTH WOODLAND BLVD DELAND, FLORIDA 32720 (386) 943-5000 JEREMY H. DILMORE, P.E. #67510	STATE OF FLORIDA DEPARTMENT OF TRANSPORTATION			SHEET NO.  IT-8
DATE	DESCRIPTION	DATE	DESCRIPTION		ROAD NO.	COUNTY	FINANCIAL PROJECT ID	
					SR 9	VOLUSIA	441133-1-52-01	

GENERAL NOTES



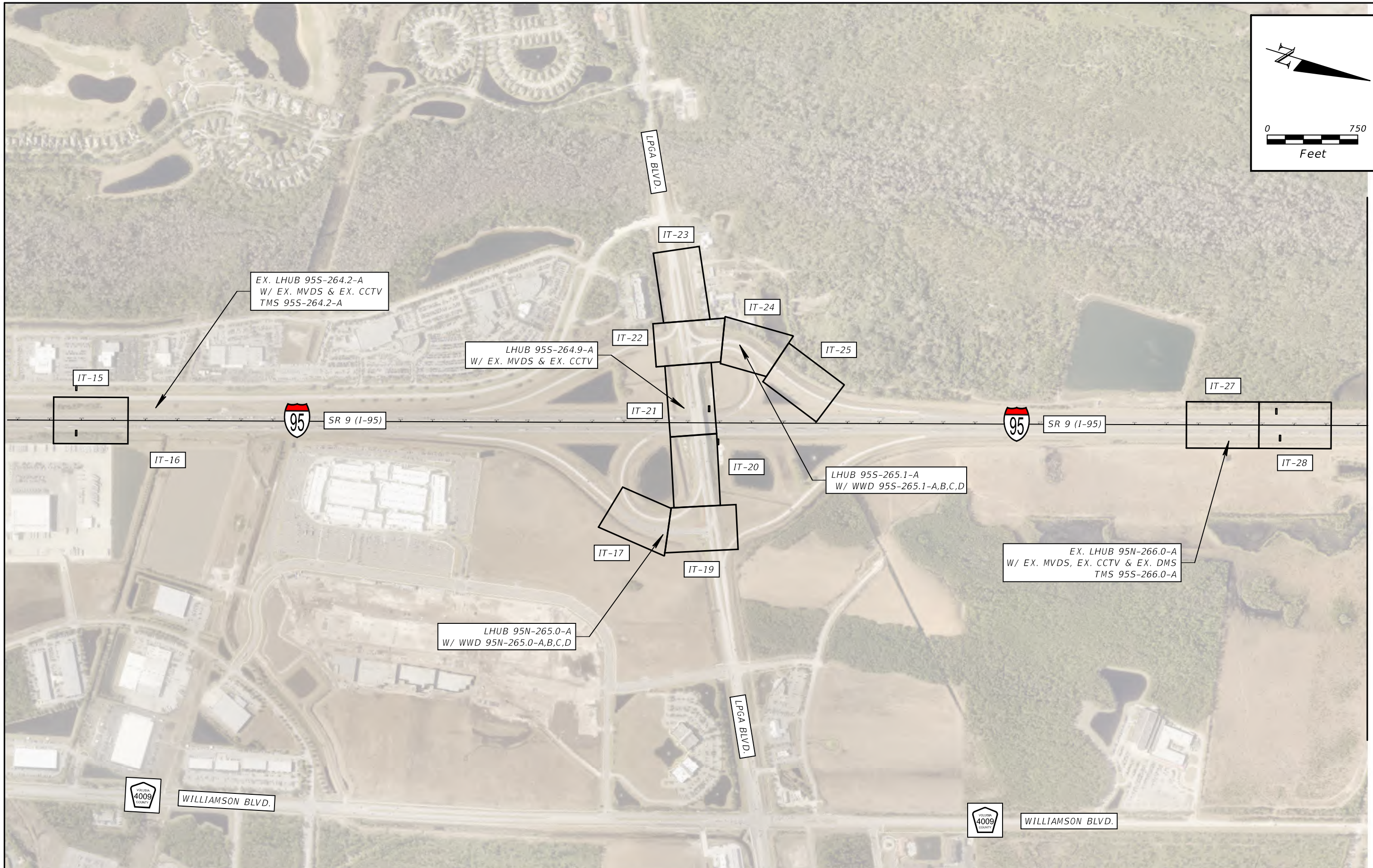
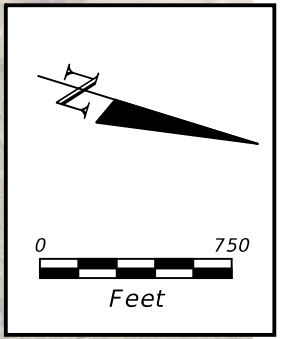

MATCH LINE A - PROJECT LAYOUT (2) (IT-10)

THE OFFICIAL RECORD OF THIS SHEET IS THE ELECTRONIC FILE DIGITALLY SIGNED AND SEALED UNDER RULE 61G15-23.004, F.A.C.

REVISIONS				FLORIDA DEPARTMENT OF TRANSPORTATION 719 SOUTH WOODLAND BLVD DELAND, FLORIDA 32720 (386) 943-5000 JEREMY H. DILMORE, P.E. #67510	STATE OF FLORIDA DEPARTMENT OF TRANSPORTATION			PROJECT LAYOUT (1)	SHEET NO.
DATE	DESCRIPTION	DATE	DESCRIPTION		ROAD NO.	COUNTY	FINANCIAL PROJECT ID		
						SR 9	VOLUSIA		441133-1-52-01



NOTE: FOR SIGNALIZATION PLANS FOR I-95 (SR 9) AND SR 40 (GRANADA BLVD) ON/OFF-RAMP NORTHBOUND AND SOUTHBOUND REFER TO IT-11 AND IT-12, RESPECTIVELY.

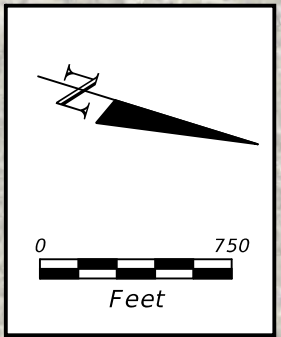

MATCH LINE A - PROJECT LAYOUT (1) (IT-9)

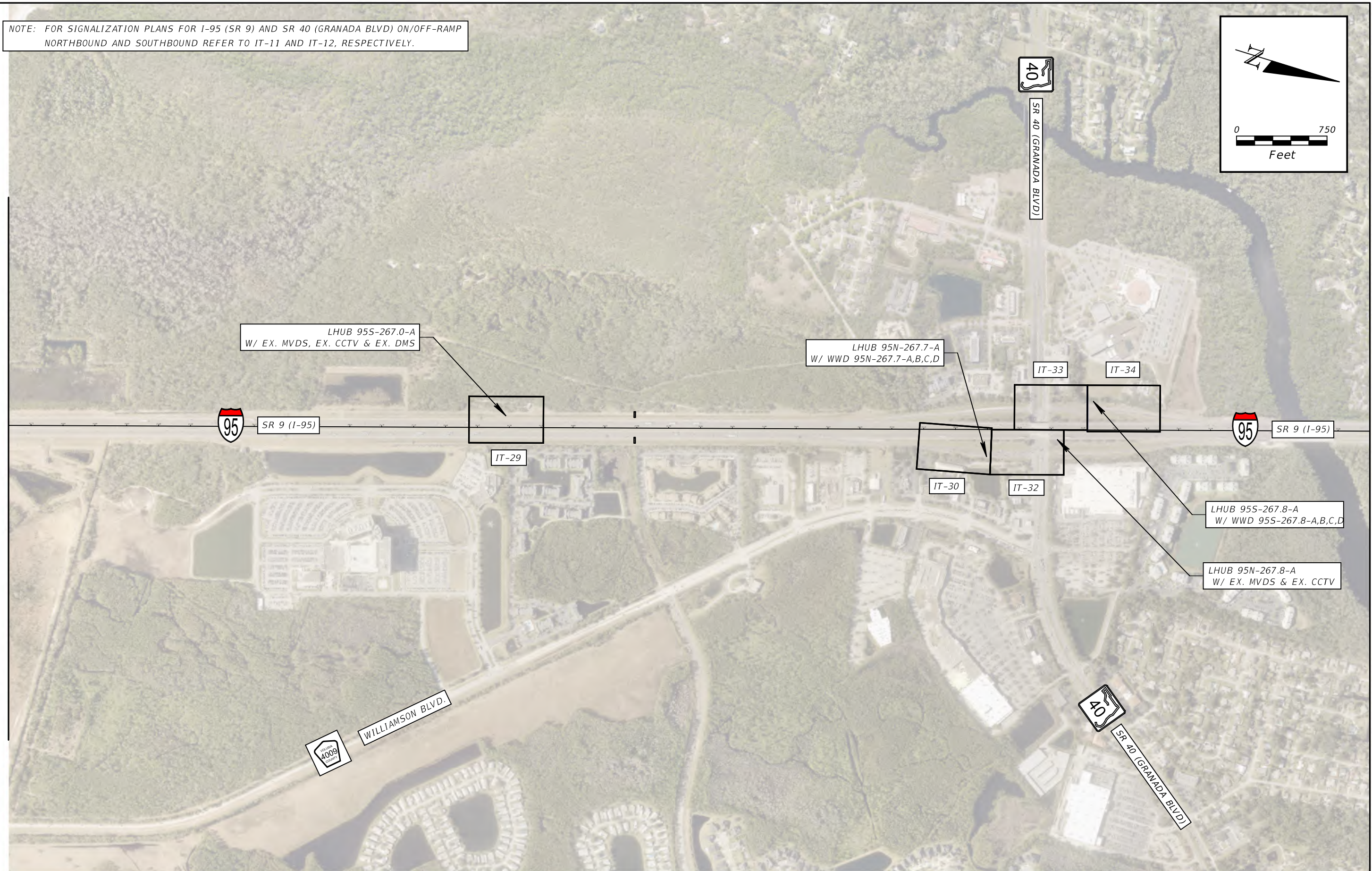

THE OFFICIAL RECORD OF THIS SHEET IS THE ELECTRONIC FILE DIGITALLY SIGNED AND SEALED UNDER RULE 61G15-23.004, F.A.C.

REVISIONS				FLORIDA DEPARTMENT OF TRANSPORTATION 719 SOUTH WOODLAND BLVD DELAND, FLORIDA 32720 (386) 943-5000 JEREMY H. DILMORE, P.E. #67510	STATE OF FLORIDA DEPARTMENT OF TRANSPORTATION			PROJECT LAYOUT (2)	SHEET NO.
DATE	DESCRIPTION	DATE	DESCRIPTION		ROAD NO.	COUNTY	FINANCIAL PROJECT ID		
						SR 9	VOLUSIA		441133-1-52-01



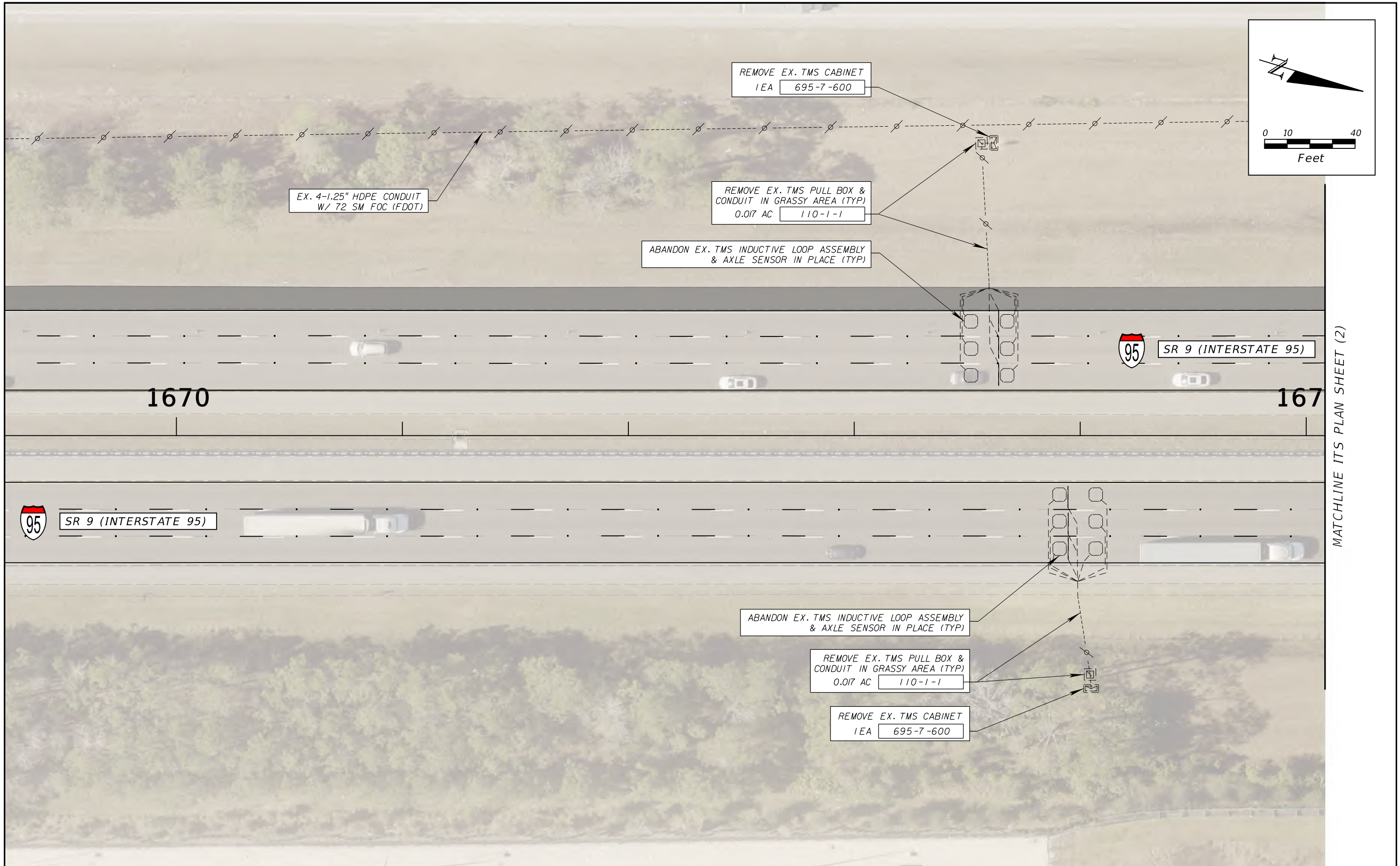

REVISIONS				FLORIDA DEPARTMENT OF TRANSPORTATION 719 SOUTH WOODLAND BLVD DELAND, FLORIDA 32720 (386) 943-5000 JEREMY H. DILMORE, P.E. #67510	STATE OF FLORIDA DEPARTMENT OF TRANSPORTATION			<b>ITS PLAN SHEET (1)</b>	SHEET NO. IT-15
DATE	DESCRIPTION	DATE	DESCRIPTION		ROAD NO.	COUNTY	FINANCIAL PROJECT ID		
					SR 9	VOLUSIA	441133-1-52-01		



MATCHLINE ITS PLAN SHEET (1)

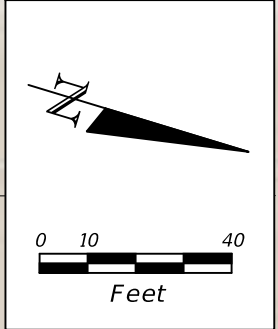
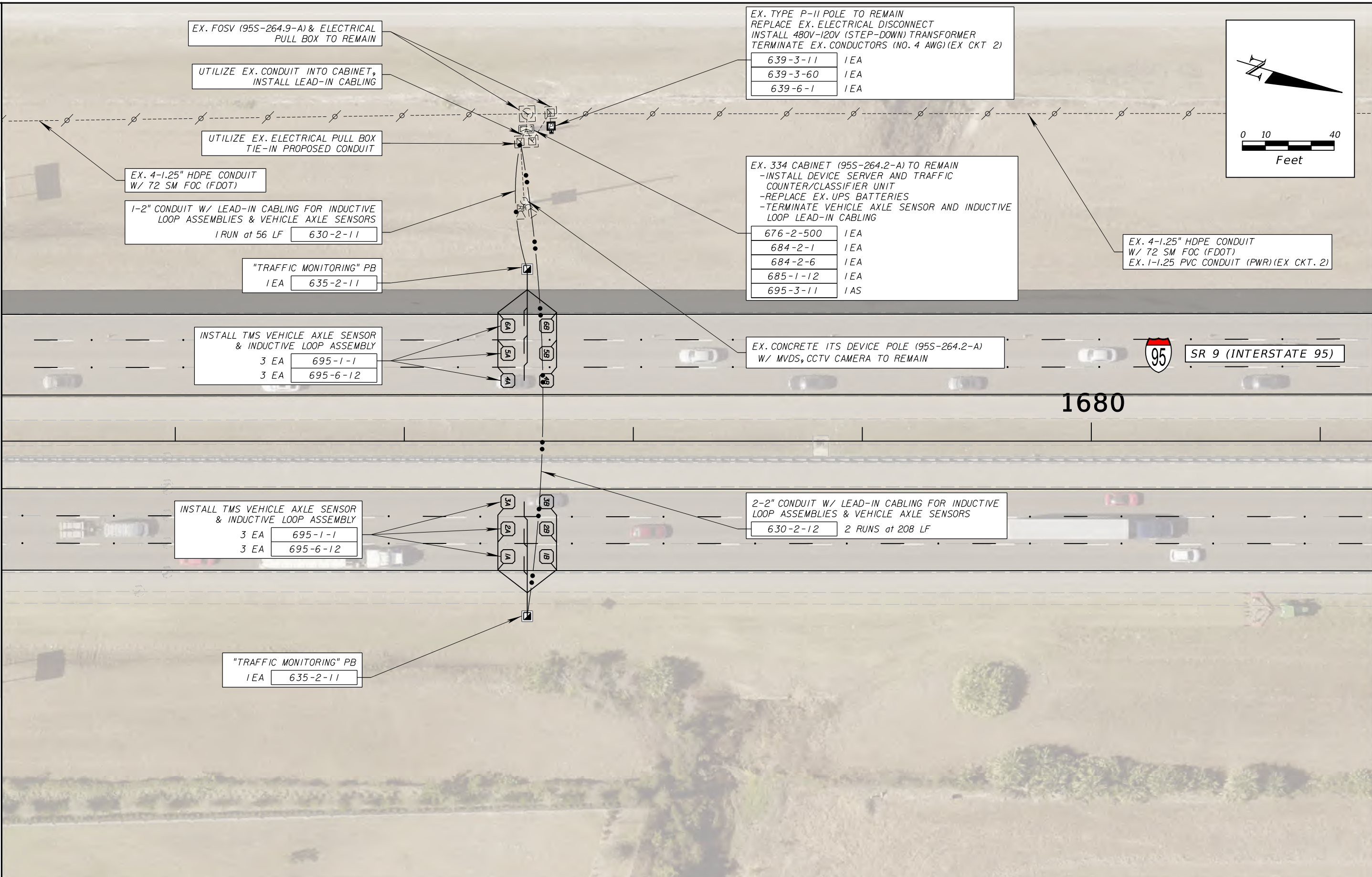

1680



REVISIONS				FLORIDA DEPARTMENT OF TRANSPORTATION 719 SOUTH WOODLAND BLVD DELAND, FLORIDA 32720 (386) 943-5000 JEREMY H. DILMORE, P.E. #67510	STATE OF FLORIDA DEPARTMENT OF TRANSPORTATION			ITS PLAN SHEET (2)	SHEET NO. IT-16
DATE	DESCRIPTION	DATE	DESCRIPTION		ROAD NO.	COUNTY	FINANCIAL PROJECT ID		
					SR 9	VOLUSIA	441133-1-52-01		

THE OFFICIAL RECORD OF THIS SHEET IS THE ELECTRONIC FILE DIGITALLY SIGNED AND SEALED UNDER RULE 61G15-23.004, F.A.C.



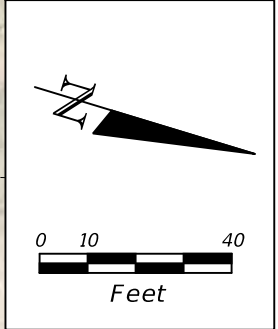
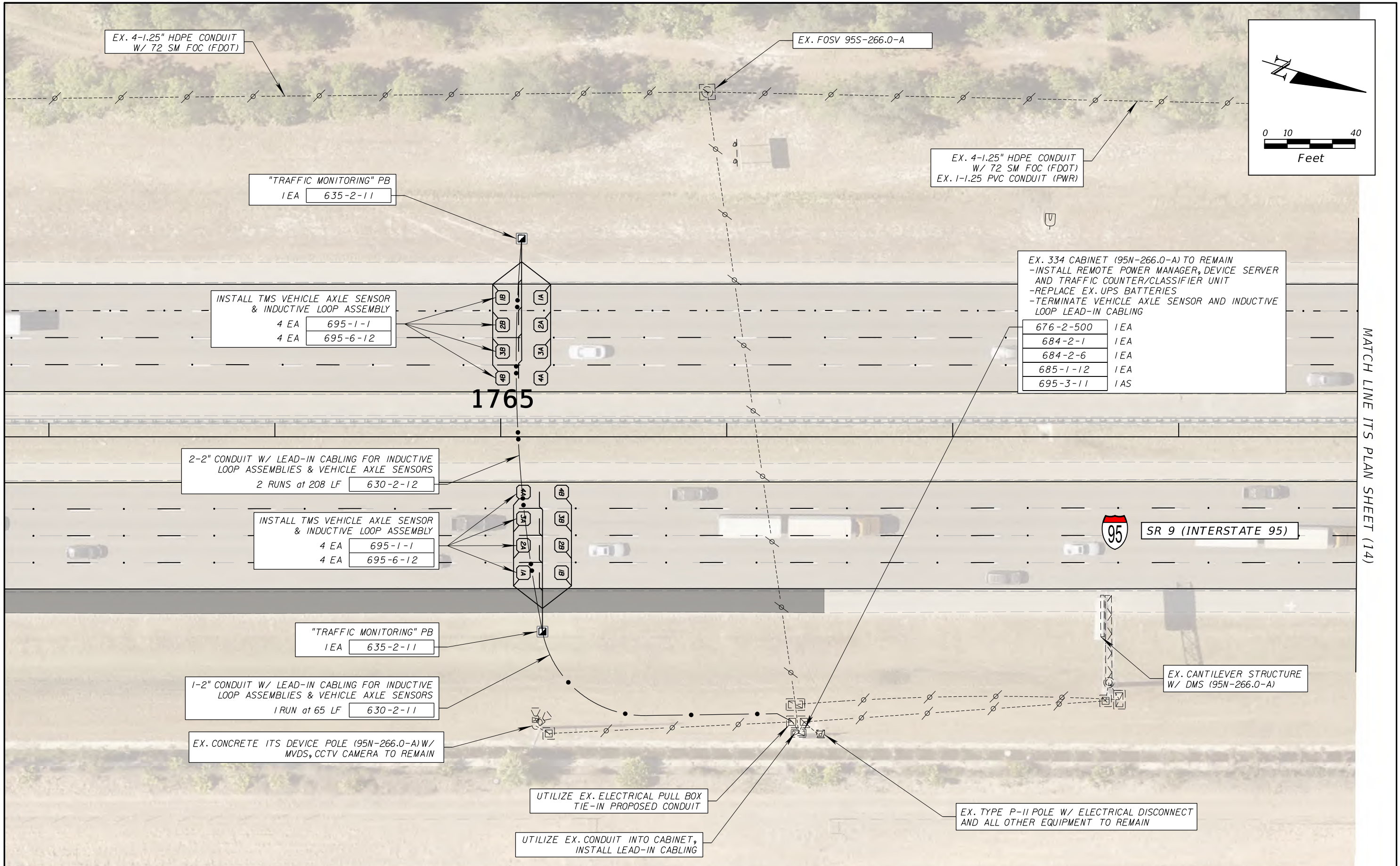

MATCH LINE ITS PLAN SHEET (14)

THE OFFICIAL RECORD OF THIS SHEET IS THE ELECTRONIC FILE DIGITALLY SIGNED AND SEALED UNDER RULE 61G15-23.004, F.A.C.

REVISIONS				FLORIDA DEPARTMENT OF TRANSPORTATION 719 SOUTH WOODLAND BLVD DELAND, FLORIDA 32720 (386) 943-5000 JEREMY H. DILMORE, P.E. #67510	STATE OF FLORIDA DEPARTMENT OF TRANSPORTATION			<b>ITS PLAN SHEET (13)</b>	SHEET NO. IT-27
DATE	DESCRIPTION	DATE	DESCRIPTION		ROAD NO.	COUNTY	FINANCIAL PROJECT ID		
					SR 9	VOLUSIA	441133-1-52-01		





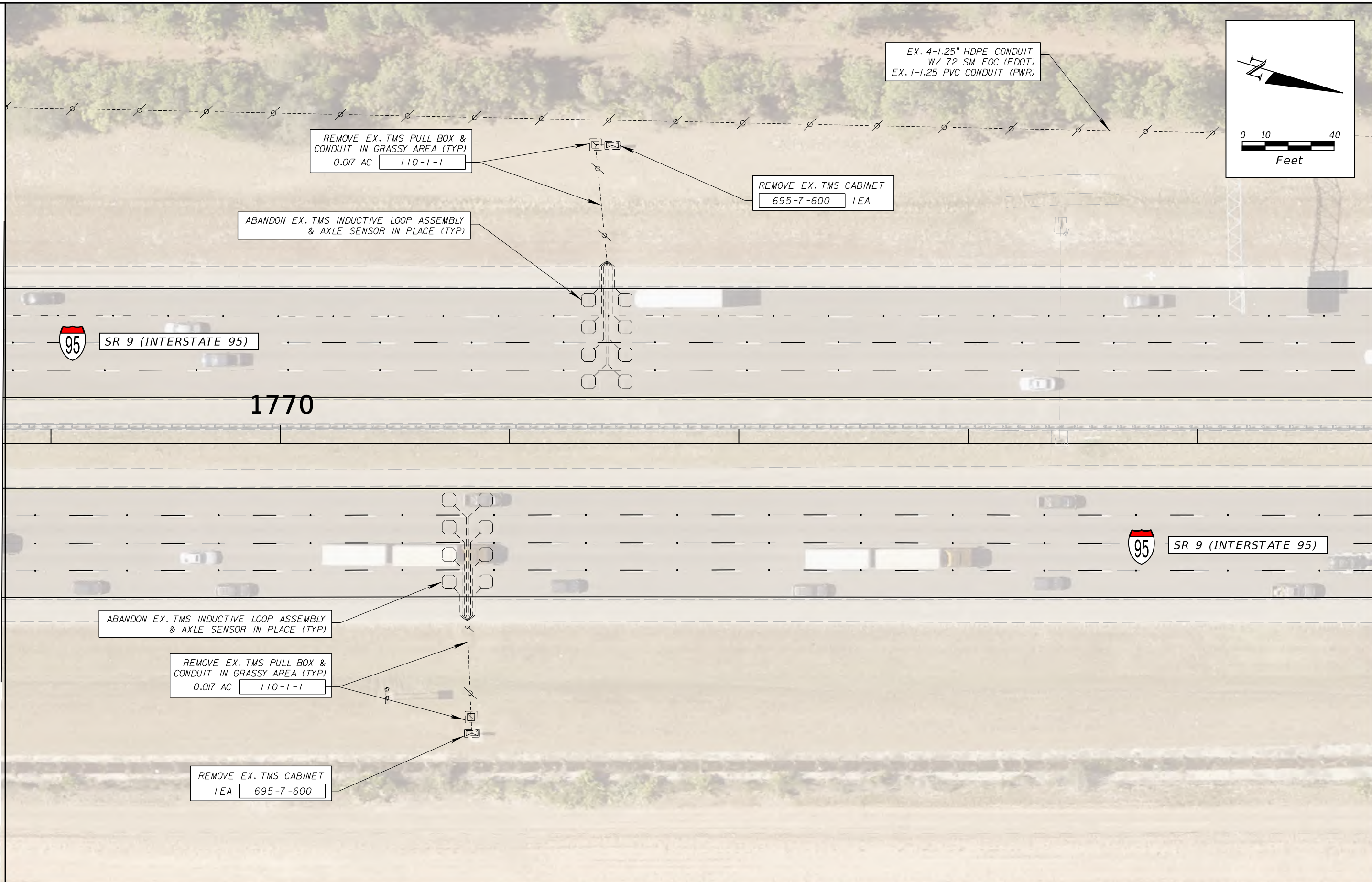

MATCH LINE ITS PLAN SHEET (13)



THE OFFICIAL RECORD OF THIS SHEET IS THE ELECTRONIC FILE DIGITALLY SIGNED AND SEALED UNDER RULE 61G15-23.004, F.A.C.

REVISIONS				FLORIDA DEPARTMENT OF TRANSPORTATION 719 SOUTH WOODLAND BLVD DELAND, FLORIDA 32720 (386) 943-5000 JEREMY H. DILMORE, P.E. #67510	STATE OF FLORIDA DEPARTMENT OF TRANSPORTATION			ITS PLAN SHEET (14)	SHEET NO.
DATE	DESCRIPTION	DATE	DESCRIPTION		ROAD NO.	COUNTY	FINANCIAL PROJECT ID		
						SR 9	VOLUSIA		441133-1-52-01

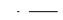
**LEGEND:**

-  EXISTING EQUIPMENT/DEVICE
-  PROPOSED EQUIPMENT/DEVICE
-  EXISTING CABLING/WIRING
-  PROPOSED CABLING/WIRING

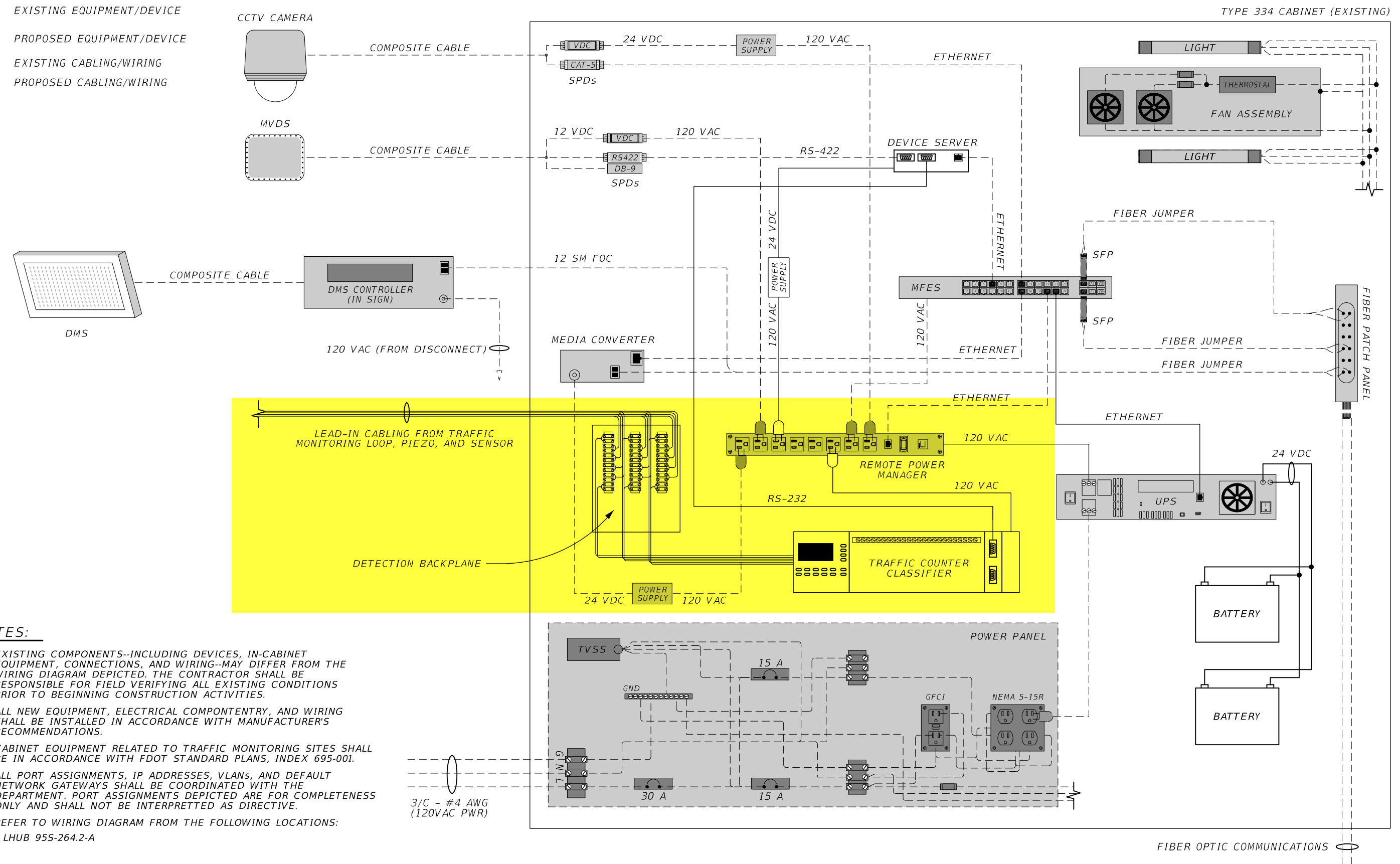

**NOTES:**

1. EXISTING COMPONENTS--INCLUDING DEVICES, IN-CABINET EQUIPMENT, CONNECTIONS, AND WIRING--MAY DIFFER FROM THE WIRING DIAGRAM DEPICTED. THE CONTRACTOR SHALL BE RESPONSIBLE FOR FIELD VERIFYING ALL EXISTING CONDITIONS PRIOR TO BEGINNING CONSTRUCTION ACTIVITIES.
2. ALL NEW EQUIPMENT, ELECTRICAL COMPONENTRY, AND WIRING SHALL BE INSTALLED IN ACCORDANCE WITH MANUFACTURER'S RECOMMENDATIONS.
3. CABINET EQUIPMENT RELATED TO TRAFFIC MONITORING SITES SHALL BE IN ACCORDANCE WITH FDOT STANDARD PLANS, INDEX 695-001.
4. ALL PORT ASSIGNMENTS, IP ADDRESSES, VLANs, AND DEFAULT NETWORK GATEWAYS SHALL BE COORDINATED WITH THE DEPARTMENT. PORT ASSIGNMENTS DEPICTED ARE FOR COMPLETENESS ONLY AND SHALL NOT BE INTERPRETTED AS DIRECTIVE.
5. REFER TO WIRING DIAGRAM FROM THE FOLLOWING LOCATIONS:  
- LHUB 955-264.2-A

REVISIONS			
DATE	DESCRIPTION	DATE	DESCRIPTION

FLORIDA DEPARTMENT OF TRANSPORTATION  
719 SOUTH WOODLAND BLVD  
DELAND, FLORIDA 32720  
(386) 943-5000  
JEREMY H. DILMORE, P.E. #67510





STATE OF FLORIDA DEPARTMENT OF TRANSPORTATION		
ROAD NO.	COUNTY	FINANCIAL PROJECT ID
SR 9	VOLUSIA	441133-1-52-01

**WIRING DIAGRAMS**

SHEET NO.  
**IT-42**

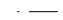

**LEGEND:**

-  EXISTING COMPONENT
-  PROPOSED COMPONENT
-  EXISTING CABLING/WIRING
-  PROPOSED CABLING/WIRING

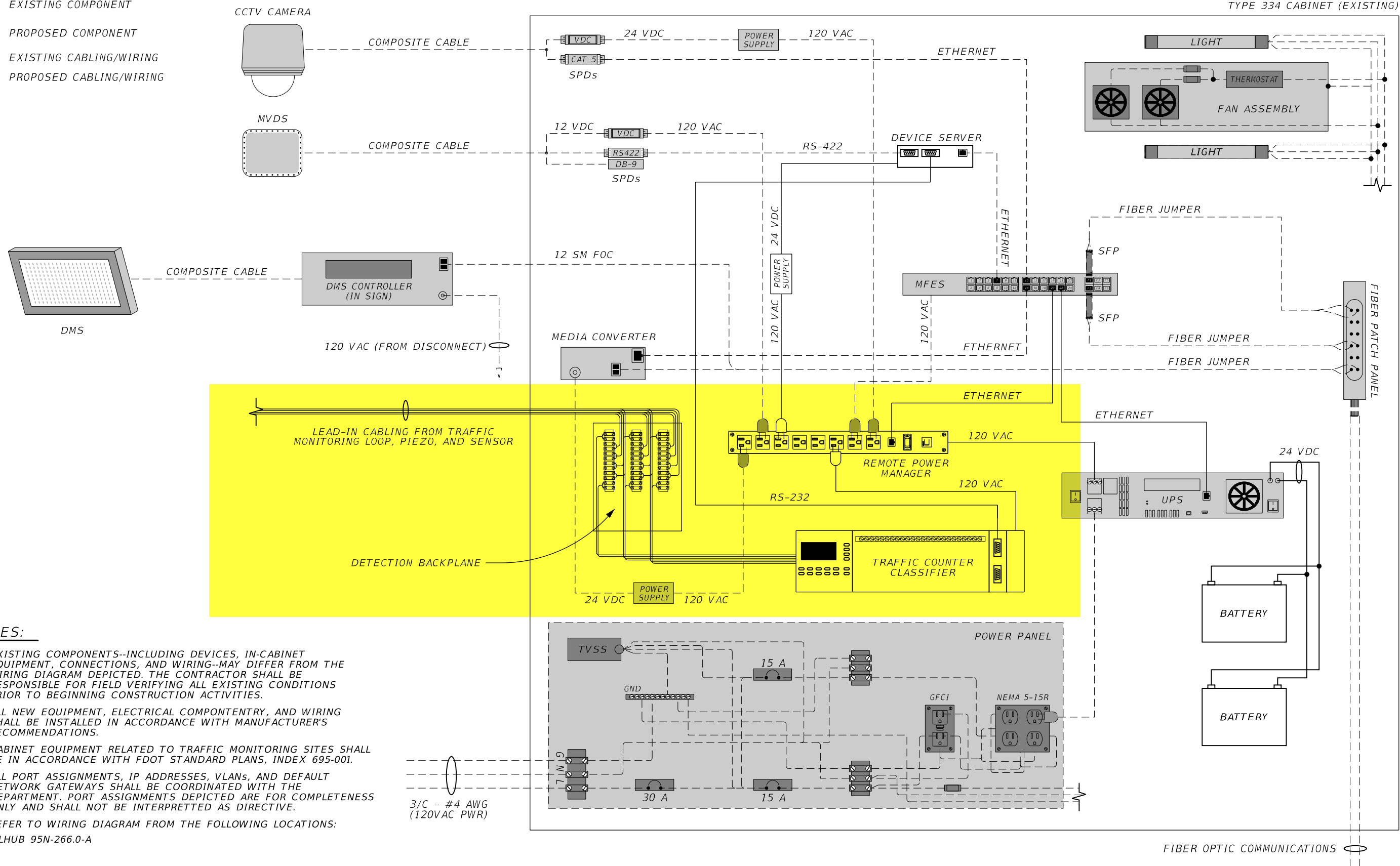

**NOTES:**

1. EXISTING COMPONENTS--INCLUDING DEVICES, IN-CABINET EQUIPMENT, CONNECTIONS, AND WIRING--MAY DIFFER FROM THE WIRING DIAGRAM DEPICTED. THE CONTRACTOR SHALL BE RESPONSIBLE FOR FIELD VERIFYING ALL EXISTING CONDITIONS PRIOR TO BEGINNING CONSTRUCTION ACTIVITIES.
2. ALL NEW EQUIPMENT, ELECTRICAL COMPONENTRY, AND WIRING SHALL BE INSTALLED IN ACCORDANCE WITH MANUFACTURER'S RECOMMENDATIONS.
3. CABINET EQUIPMENT RELATED TO TRAFFIC MONITORING SITES SHALL BE IN ACCORDANCE WITH FDOT STANDARD PLANS, INDEX 695-001.
4. ALL PORT ASSIGNMENTS, IP ADDRESSES, VLANs, AND DEFAULT NETWORK GATEWAYS SHALL BE COORDINATED WITH THE DEPARTMENT. PORT ASSIGNMENTS DEPICTED ARE FOR COMPLETENESS ONLY AND SHALL NOT BE INTERPRETTED AS DIRECTIVE.
5. REFER TO WIRING DIAGRAM FROM THE FOLLOWING LOCATIONS:  
- LHUB 95N-266.0-A

3/C - #4 AWG  
(120VAC PWR)

REVISIONS			
DATE	DESCRIPTION	DATE	DESCRIPTION

FLORIDA DEPARTMENT OF TRANSPORTATION  
719 SOUTH WOODLAND BLVD  
DELAND, FLORIDA 32720  
(386) 943-5000  
JEREMY H. DILMORE, P.E. #67510

STATE OF FLORIDA DEPARTMENT OF TRANSPORTATION		
ROAD NO.	COUNTY	FINANCIAL PROJECT ID
SR 9	VOLUSIA	441133-1-52-01

**WIRING DIAGRAMS**

SHEET NO.

IT-43



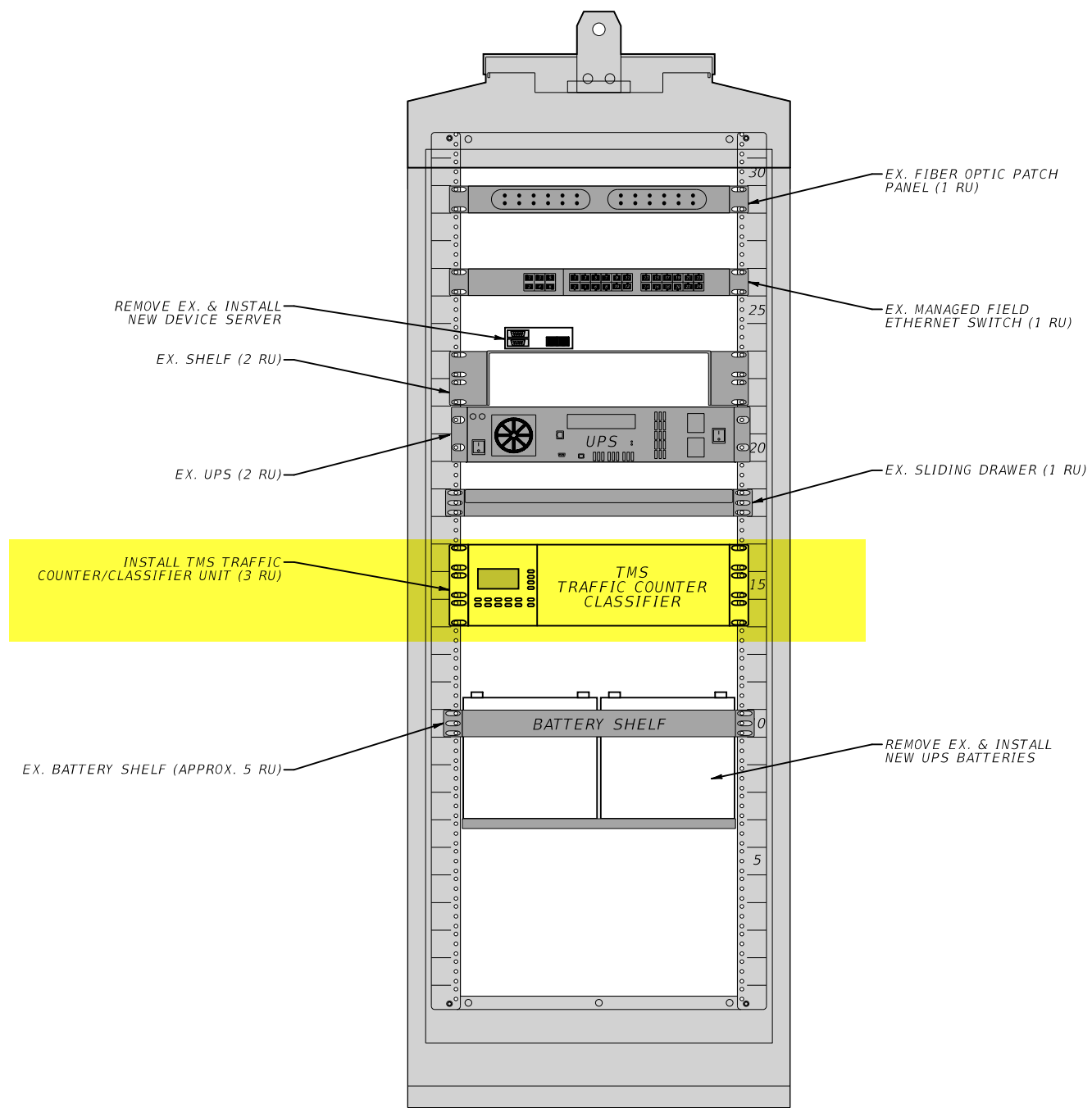

FRONT VIEW

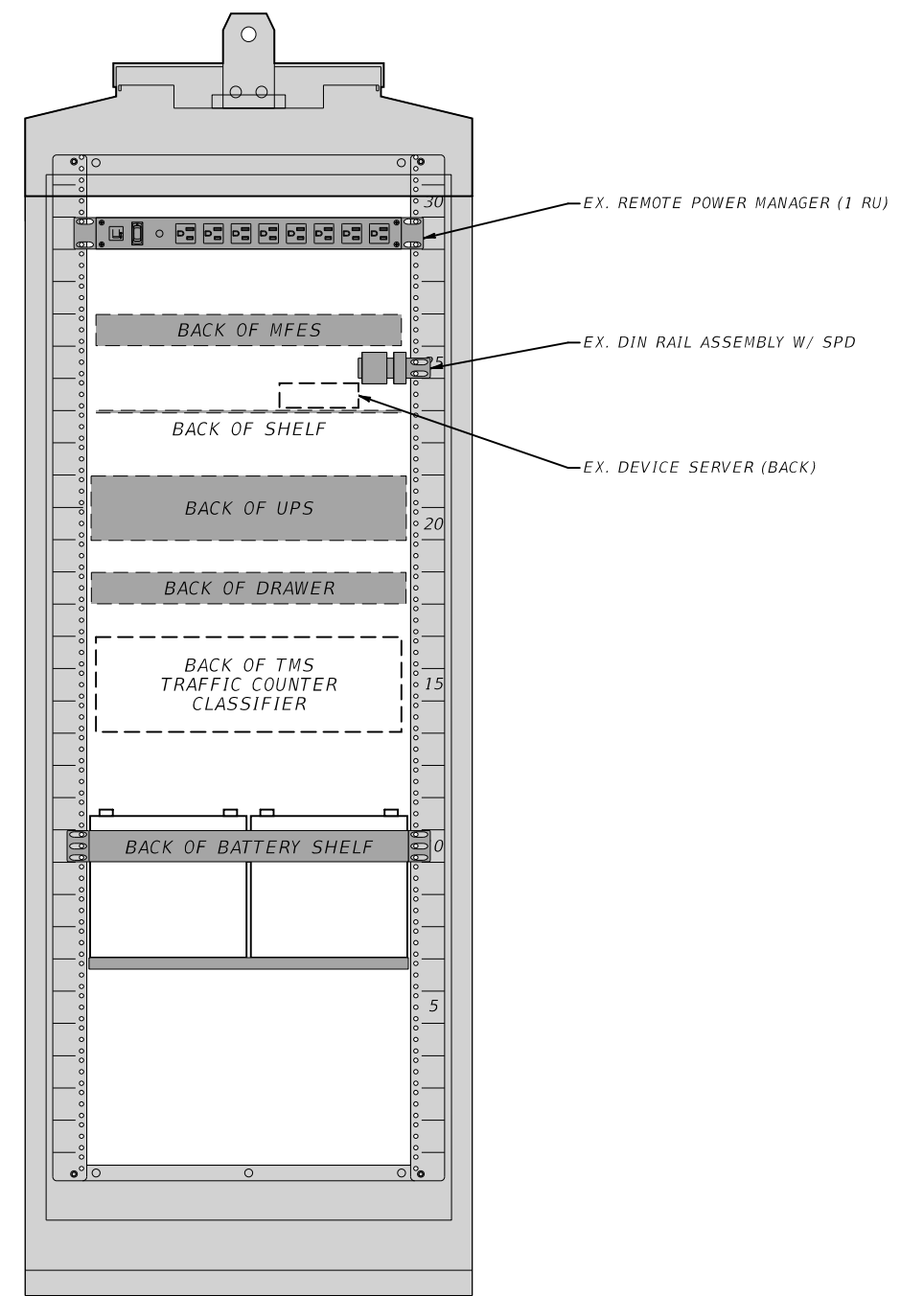

BACK VIEW

EX. TYPE 334 CABINET (95S-264.2-A)

LEGEND:

- PROPOSED, RACK UNIT OCCUPIED (FRONT)
- EXISTING, RACK UNIT OCCUPIED (FRONT)
- PROPOSED (FUTURE)
- PROPOSED, RACK UNIT AVAILABLE (REAR)
- EXISTING, RACK UNIT AVAILABLE (REAR)

REVISIONS			
DATE	DESCRIPTION	DATE	DESCRIPTION

FLORIDA DEPARTMENT OF TRANSPORTATION  
 719 SOUTH WOODLAND BLVD  
 DELAND, FLORIDA 32720  
 (386) 943-5000  
 JEREMY H. DILMORE, P.E. #67510

STATE OF FLORIDA DEPARTMENT OF TRANSPORTATION		
ROAD NO.	COUNTY	FINANCIAL PROJECT ID
SR 9	VOLUSIA	441133-1-52-01

CABINET DETAILS

SHEET NO.  
IT-52



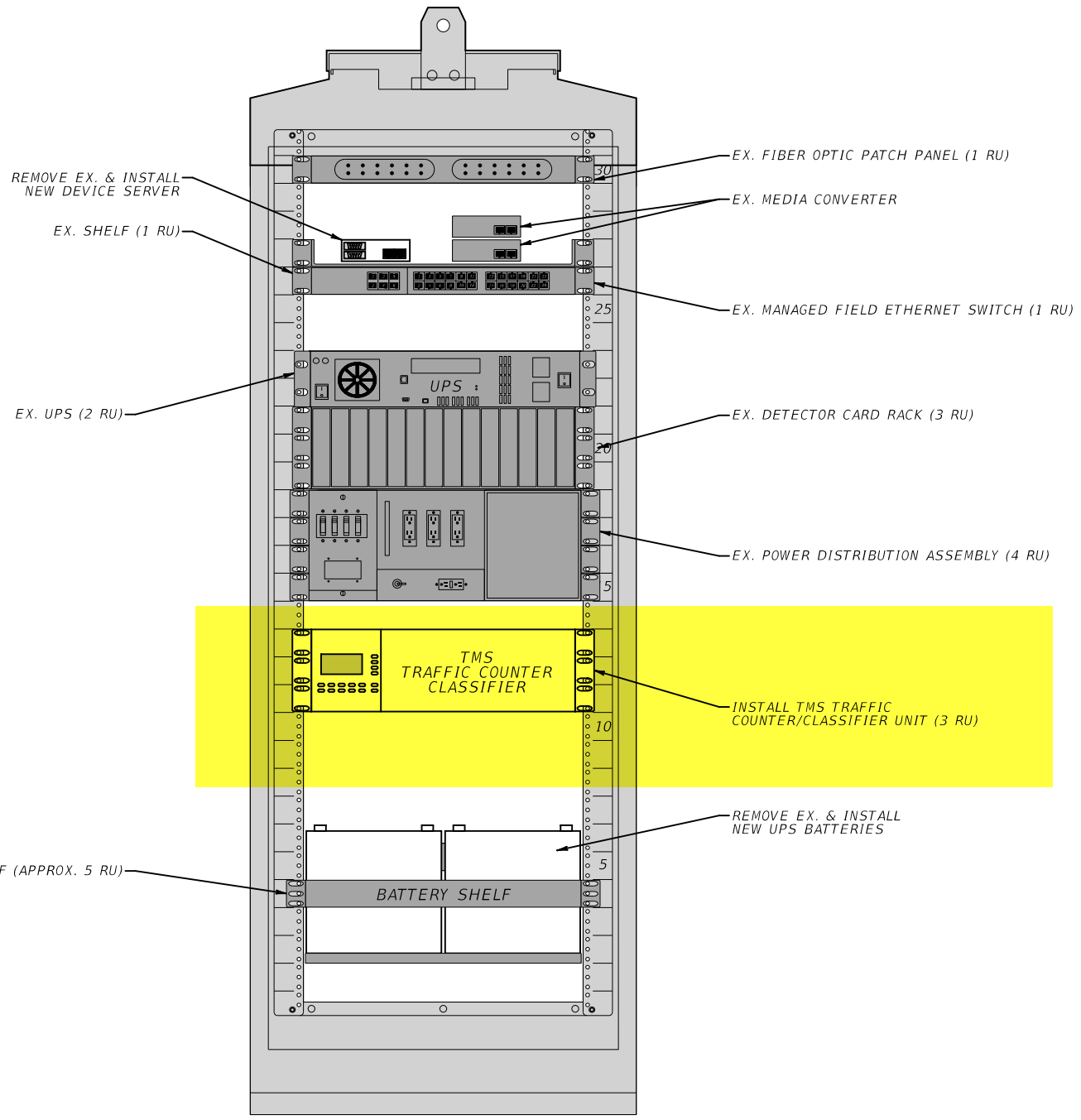

FRONT VIEW

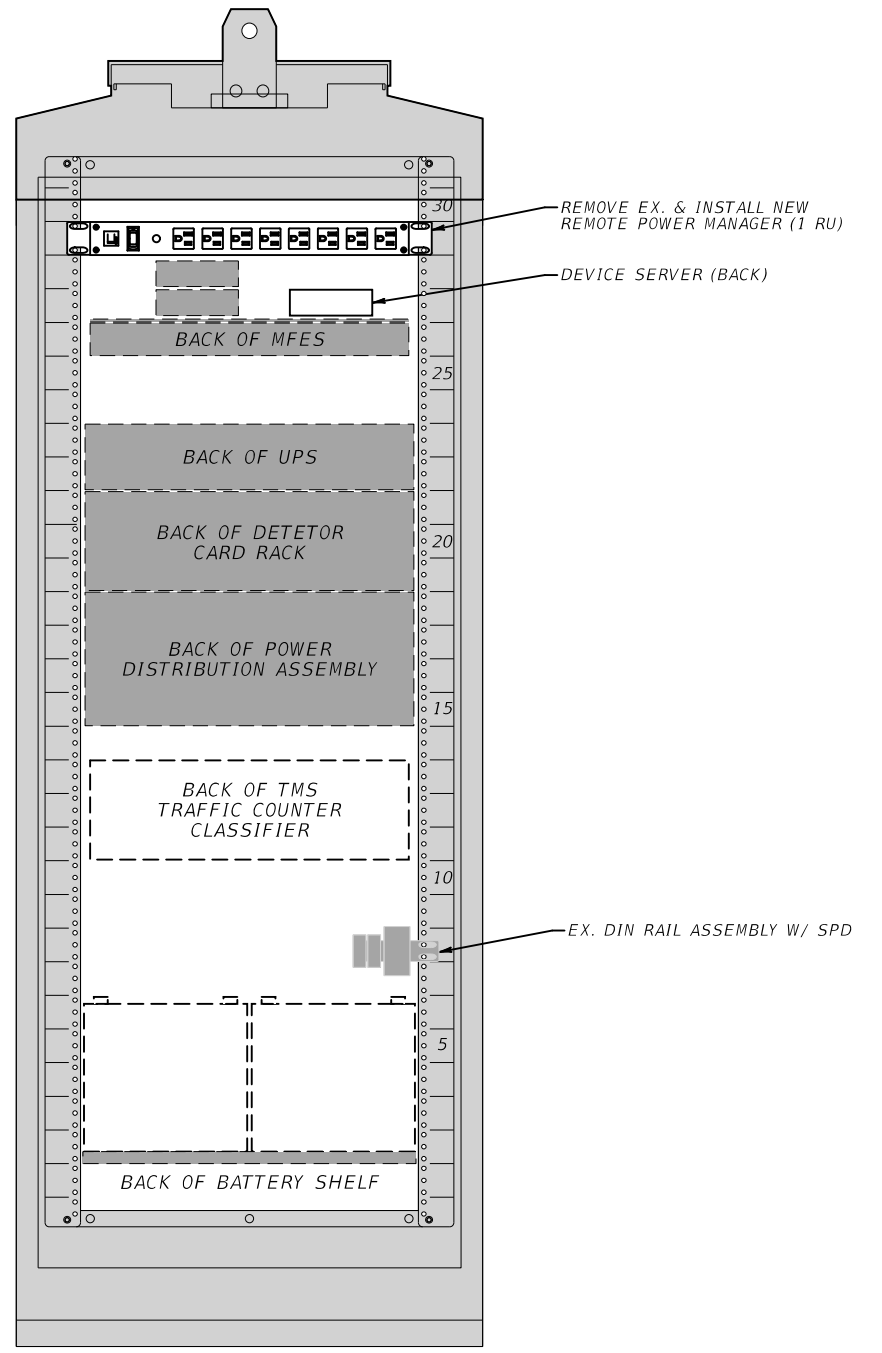

BACK VIEW

LEGEND:

- PROPOSED, RACK UNIT OCCUPIED (FRONT)
- EXISTING, RACK UNIT OCCUPIED (FRONT)
- PROPOSED (FUTURE)
- PROPOSED, RACK UNIT AVAILABLE (REAR)
- EXISTING, RACK UNIT AVAILABLE (REAR)

EX. TYPE 334 CABINET (95N-266.0-A)

REVISIONS				FLORIDA DEPARTMENT OF TRANSPORTATION 719 SOUTH WOODLAND BLVD DELAND, FLORIDA 32720 (386) 943-5000 JEREMY H. DILMORE, P.E. #67510	STATE OF FLORIDA DEPARTMENT OF TRANSPORTATION			CABINET DETAILS	SHEET NO.
DATE	DESCRIPTION	DATE	DESCRIPTION		ROAD NO.	COUNTY	FINANCIAL PROJECT ID		IT-54
					SR 9	VOLUSIA	441133-1-52-01		